

# BROADGATE PARK

## PARENT GUIDE 19/20



**DOWNLOAD  
OUR APP**

 home at halls

**BROADGATE PARK**  
The place to be

+44 (0)115 951 8670  
[broadgatepark@upp-ltd.com](mailto:broadgatepark@upp-ltd.com)



University of  
Nottingham  
UK | CHINA | MALAYSIA

in  
partnership  
with



# CHECKLIST

## REGISTER AT THE UNIVERSITY OF NOTTINGHAM

Encourage online pre-registration.

All new full-time students must also confirm their attendance in person as per University instruction.

## DOWNLOAD THE SU APP

Your son/daughter will find the most up-to-date information for all Welcome events, campus maps so they never feel lost, useful contacts if they need support and information about upcoming elections. Suitable for both Apple and android devices.

## PARCEL LOCKERS AMAZON

We have an Amazon locker onsite - add this to your Amazon address book. The name of the locker is 'Vine'.

## UniDrop LOCKER

All couriers are directed to use this if they are unable to get in touch with you whilst on site.

## COMPLETE THE E-INDUCTION

Your son/daughter must complete their online induction prior to arrival. This will only take around 10 mins and will provide them with important information about life at Broadgate Park.

Please ensure that you choose your arrival date once this has been complete.

## WI-FI

Our internet is provided by Glide. We advise all new arrivals register for the internet access prior to arrival.

**BROADGATE**

**ALBION HOUSE**

**CLOISTER HOUSE**

## ENDSLEIGH INSURANCE

Included in the rent is basic contents insurance, please check the cover is adequate for all personal items.

You can check the cover here and search UPP (Broadgate Park)

# PAYMENTS AND KEY DATES

Term 1 and  
deposit due  
**5th Sept 19**

Term 2 due  
**20th Jan 20**

Term 3 due  
**11th May 20**

All payments must be made direct to the University via the [MyNottingham portal](#) or by bank transfer using the information given in this link - [University payment information](#)

If reliant upon a UK student loan please note that the damage deposit of £250.00 plus a £250.00 rent pre-payment must be paid by 5th September 2019.

Please [email us](#) to confirm when the payments have been made towards the rent and deposit.

## LICENCE DATES

**Undergraduates - 20th September 2019 - 24th July 2020**

**Postgraduates - 20th September 2019 - 11th September 2020**

**Semester 1 - 21st September 2019 - 24th January 2020**

**Semester 2 - 26th January 2020 - 20th June 2020**

# ROOM DETAILS

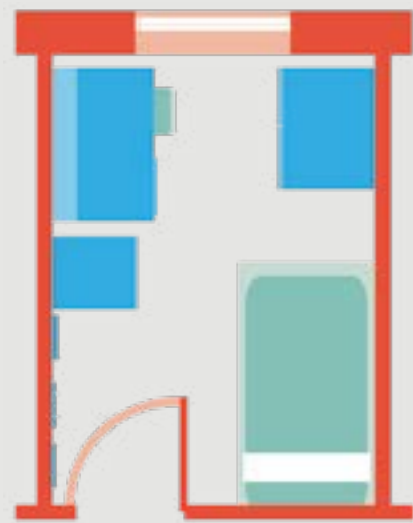

Please note room layouts may vary

## STANDARD BEDROOM/ LARGE STANDARD BEDROOM

### Items in the bedroom

Bed  
Curtains  
Wardrobe  
Desk & Chair  
Wi-Fi & Data Point  
Mirror

### Items in the communal space

Toaster  
Fridge  
Freezer  
Iron & Board  
Hob  
Microwave

Corridor,  
kitchen and  
bathroom  
cleaned once  
a week

Standard Bedroom - Single bed (Approx. 90 x 190 cm)

Large Standard Bedroom - Small double bed (Approx. 120 x 190 cm)

Take a tour of our Standard Bedroom Flat

# ROOM DETAILS

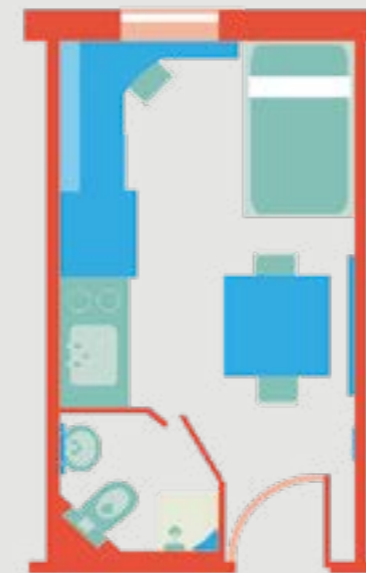

Please note room layouts may vary

## ENSUITE STUDIO/ LARGE ENSUITE STUDIO

Bed  
Curtains  
Wardrobe  
Desk & Chair  
Wi-Fi & Data Point  
Mirror  
Kettle

Fridge with chiller compartment  
Hob  
Microwave combination oven  
Dedicated ironing room (within the block)

Corridor  
cleaned once  
a week

Ensuite Studio - Single bed (Approx. 90 x 190 cm)

Large Ensuite Studio -  
Small double bed (Approx. 120 x 190 cm)

Take a tour of our Ensuite Studio Flat

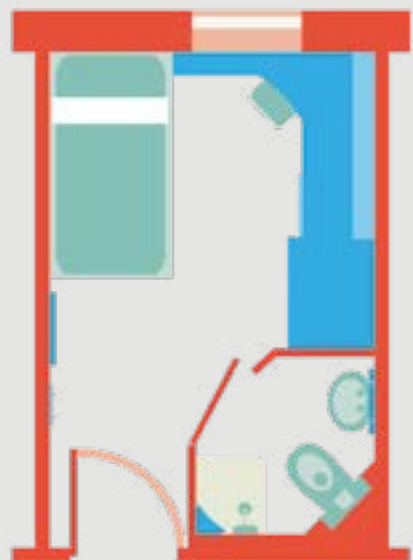

Please note room layouts may vary

## ENSUITE BEDROOM/ LARGE ENSUITE BEDROOM

### Items in the bedroom

Bed  
Curtains  
Wardrobe  
Desk & Chair  
Wi-Fi & Data Point  
Mirror

### Items in the communal space

Toaster  
Fridge  
Freezer  
Iron & Board  
Hob  
Microwave

Corridor  
and kitchen  
cleaned once  
a week

Ensuite Bedroom - Single bed (Approx. 90 x 190 cm)

Large Ensuite Bedroom - Small double bed (Approx. 120 x 190 cm)

Take a tour of our Ensuite Flat

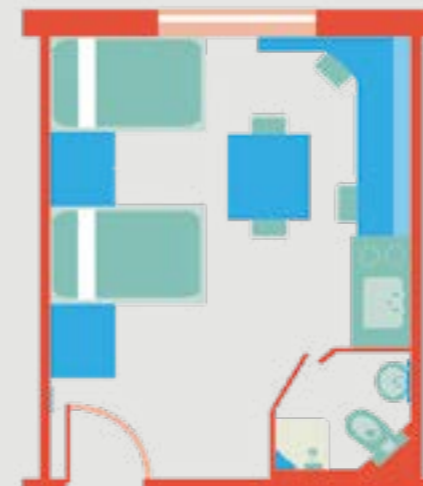

Please note room layouts may vary

## TWIN ENSUITE STUDIO/ LARGE TWIN ENSUITE STUDIO

Bed  
Curtains  
Wardrobe  
Desk & Chair  
Wi-Fi & Data Point  
Mirror  
Kettle

Fridge with chiller compartment  
Hob  
Microwave combination oven  
Dedicated ironing room (within the block)

Corridor  
cleaned once  
a week

Twin Ensuite Studio -  
2x Single bed (Approx. 90 x 190cm)

Large Twin Ensuite Studio -  
2x Single bed (90 x 190cm)

Take a tour of our Twin Ensuite Studio Flat



# WHAT TO BRING

## BEDDING AND TOWELS

Bed linen (fitted base sheet, duvet, pillows and covers)  
Hand Towel/Bath towel

## COOKING EQUIPMENT

Crockery (plate, bowl, mug and a glass)  
Sauce pan/frying pan  
Baking tray  
Tea towels  
Cutlery and cooking utensils (wooden spoon etc.)

## OTHER ESSENTIALS

Clothes hangers (these are not provided)  
Warm coat, hat, gloves and a scarf  
Umbrella  
Toilet paper

## BEDDING PACKS

Bedding packs can be purchased at Reception on arrival. The pack consists of a hand towel, bath towel, fitted base sheet, duvet, pillow and covers.

£25  
Single

£35  
Double

## VIEW OUR WHAT TO BRING VIDEO



# PROHIBITED ITEMS

## ANIMALS

## FAIRY LIGHTS

Unless battery operated

## CANDLES/INCENSE/JOSS STICKS

Or any items with a naked/covered flame

## CHIP PANS & DEEP FAT FRYERS

These are a high risk fire hazard

## CONVECTOR/FAN/HALOGEN HEATERS

Oil filled heaters are authorised

## MINI FRIDGES

Medical fridges are available, please contact [broadgatepark@upp-ltd.com](mailto:broadgatepark@upp-ltd.com) to arrange, subject to condition

The above list is not exhaustive and provided as a guide only. If you have any concerns about an item please contact Reception.

Room visits are carried out twice a year by the Residence Team. If prohibited items are found during visits, this will be raised as a concern and a course of action will be agreed upon.

If your son/daughter wish to bring a rice cooker please ensure this is kept ONLY in the communal kitchen (studio excluded)

# USING THE SPACE SAFELY

## VIEW OUR VIDEO ON SAFE USE OF UK POWER OUTLETS



## PREVENTION MEASURES

For safety reasons, our detection devices are highly sensitive and can be triggered by smoke, excessive steam or even aerosols. Close bathroom doors when showering. Never leave cooking unattended and always ventilate the area with the cooker hood and open windows. Smoking, vaping, naked or covered flames and deep fat frying are not permitted.

## GENERAL SAFETY TIPS

- Doors should never be propped open (including fire doors).
- Keys should always be carried about the person to keep them safe. Keys should never be given to anyone else.
- Encourage awareness of strangers on the premises. If they are not sure who someone is they should ask them or alert the staff.
- Doors should always be locked when going out and should be kept closed at all times even if just nipping to the kitchen/bathroom.
- If residents see anything suspicious they should report it to staff as soon as possible.
- If the room is at ground level or easily accessible from the ground, remind your son/daughter to shut the window before they go out. Windows will only tilt outwards and should not open fully.

# FIRE SAFETY

## NEED TO KNOW INFORMATION



## IDENTIFY THE FIRE ASSEMBLY POINT

(these are displayed in the flat)



IF A FIRE IS DISCOVERED  
DO NOT USE FIRE  
EXTINGUISHERS/BLANKETS.



FIRE  
BLANKET



Your son/daughter should close all doors behind them, break the glass on their nearest call point and evacuate the building.

IT'S A CRIMINAL OFFENCE TO TAMPER WITH FIRE EQUIPMENT AND STUDENTS WILL BE FINED FOR MISUSE, AS WELL AS BEING CHARGED FOR REPLACING EQUIPMENT. DO NOT REMOVE THE TAGS FROM THE FIRE EXTINGUISHERS AND DETECTORS MUST NOT BE COVERED UNDER ANY CIRCUMSTANCE.



FIRE DOORS SHOULD REMAIN CLOSED AT ALL TIMES AND SHOULD NOT BE WEDGED OPEN, DOING SO WILL POSE A SERIOUS SECURITY AND FIRE RISK.

SHOULD ANYONE BECOME AWARE OF A FIRE OR A HAZARD THAT COULD DEVELOP INTO A FIRE THEY SHOULD CONTACT RECEPTION IMMEDIATELY.



## FIRE ALARM TEST



## EVERY THURSDAY

If alarm sounds for longer than 60 seconds, residents should proceed to their assembly point

# ONSITE FACILITIES

## LEVEL 1



Level 1 was developed with students in mind creating The Lounge and The Library spaces.

The Lounge allows students to relax and unwind with access to gaming stations, table football and comfy seating around our projector screen, whilst The Library has study areas for both group and individual work.

## PARKING



Parking permits are available for £300 per year.

Click here to download an application.

Fixed penalty notices of £75 will be applied to non-permit holders or failing to display a permit.

(Parking regulations do not apply during intake)  
ALL visitors must report to the Reception.

## LAUNDRY



The Reception laundry and Albion House laundry rooms operate on the circuit laundry app. Our other laundries across the site operate on a cash basis. All laundries are £2 to wash and £1 to dry-exact change is required in the cash operated laundries.

## POST AND PARCELS

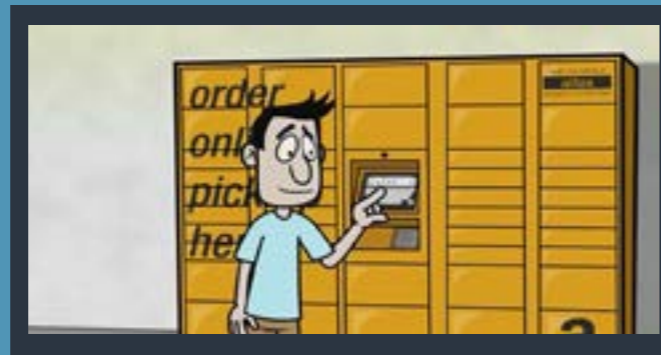

Each flat has a shared mailbox which Royal Mail can access for delivery of letters and small parcels. Encourage your son/daughter to add a contact number for packages so delivery drivers can contact you.

For delivery to our Reception Amazon locker, add 'Vine' to the address book. If the UniDrop multi courier parcel locker has been used for deliveries the student will be notified by text.

# THE LOCAL AREA

## ALBION HOUSE AND BROADGATE PARK

Albion House and Broadgate Park are both located in the lively Nottingham suburb of Beeston. As well as using excellent local facilities, the following links provide a short insight into the local area.

## ALBION HOUSE

## BROADGATE PARK

### SUPERMARKETS

#### Tesco Extra (Beeston) NG9 2WJ

Mon – Sat 6am - 12am

Sun 11am - 5pm

0.4 miles from Albion

0.9 miles from Broadgate

#### Sainsbury's (Beeston) NG9 2LA

Mon – Fri 8am - 10pm

Sat 7am - 10pm

Sun 10am - 4pm

0.1 miles from Albion

0.6 miles from Broadgate

#### Lidl (Beeston) NG9 2NG

Mon – Sat 8am - 10pm

Sun 10am - 4pm

0.1 miles from Albion

0.8 miles from Broadgate

#### Co-op (Beeston) NG9 2GJ

Mon – Sun 7am - 11pm

0.7 miles from Albion

0.2 miles from Broadgate

### TRANSPORT

#### DG Cars

0115 9500 500

[dgcars.co.uk](http://dgcars.co.uk)



Albion House and Broadgate Park are in close proximity to a number of major bus routes heading into the city and Beeston. The tram is also easily accessible.

#### Trent Barton's Indigo service

[trentbarton.co.uk/services/indigo](http://trentbarton.co.uk/services/indigo)

#### Your Bus' Y36 service

[catchyourbus.co.uk/y36/index.html](http://catchyourbus.co.uk/y36/index.html)

#### Nottingham City Transport's 36 service

[goo.gl/GP0zJe](http://goo.gl/GP0zJe)

#### Nottingham Express Transit's Tram service

[thetram.net/](http://thetram.net/)



# THE LOCAL AREA

## CLOISTER HOUSE

# USEFUL INFORMATION

Dunkirk is home to Queens Medical Centre, Showcase Cinema and a great student pub, The Johnson Arms. Cloister House is in the heart of this community favoured for pubs, takeaways and the Redfield Way entertainment park. The following link provides a short insight to the local area.

## CLOISTER HOUSE

### SUPERMARKETS

**Tesco Express (Castle Boulevard)**  
NG7 1SA  
Mon – Sun 7am - 11pm  
0.5 miles from Cloister House

**Sainsbury's (Castle Marina)**  
NG7 1GX  
Mon - Fri 7am - 11pm  
Sat 7am - 10pm  
Sun 10am - 4pm  
0.9 miles from Cloister House

**SPAR**  
NG7 2JW  
Mon - Fri 8.30am - 9.30pm  
Sat 9am - 5.30pm  
Sun 11.30 am - 5.30pm  
0.4 mile from Cloiser House

### TRANSPORT

**DG Cars**  
0115 9500 500  
[dgcars.co.uk](http://dgcars.co.uk)



Cloister House is in close proximity to both the major bus routes and tram line.

**Trent Barton's Skylink service**  
[trentbarton.co.uk/services/skylinknottingham](http://trentbarton.co.uk/services/skylinknottingham)

**Your Bus' Y5 service**  
[catchyourbus.co.uk/y5/index.html](http://catchyourbus.co.uk/y5/index.html)

**Nottingham City Transport's 34 service**  
[goo.gl/6cajX9](http://goo.gl/6cajX9)

**Nottingham Express Transit's Tram service**  
[thetram.net/](http://thetram.net/)

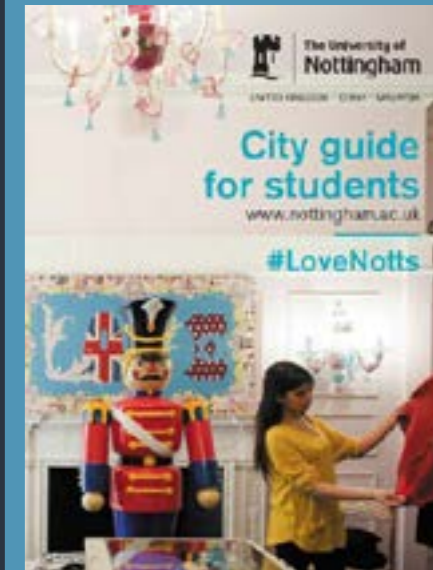
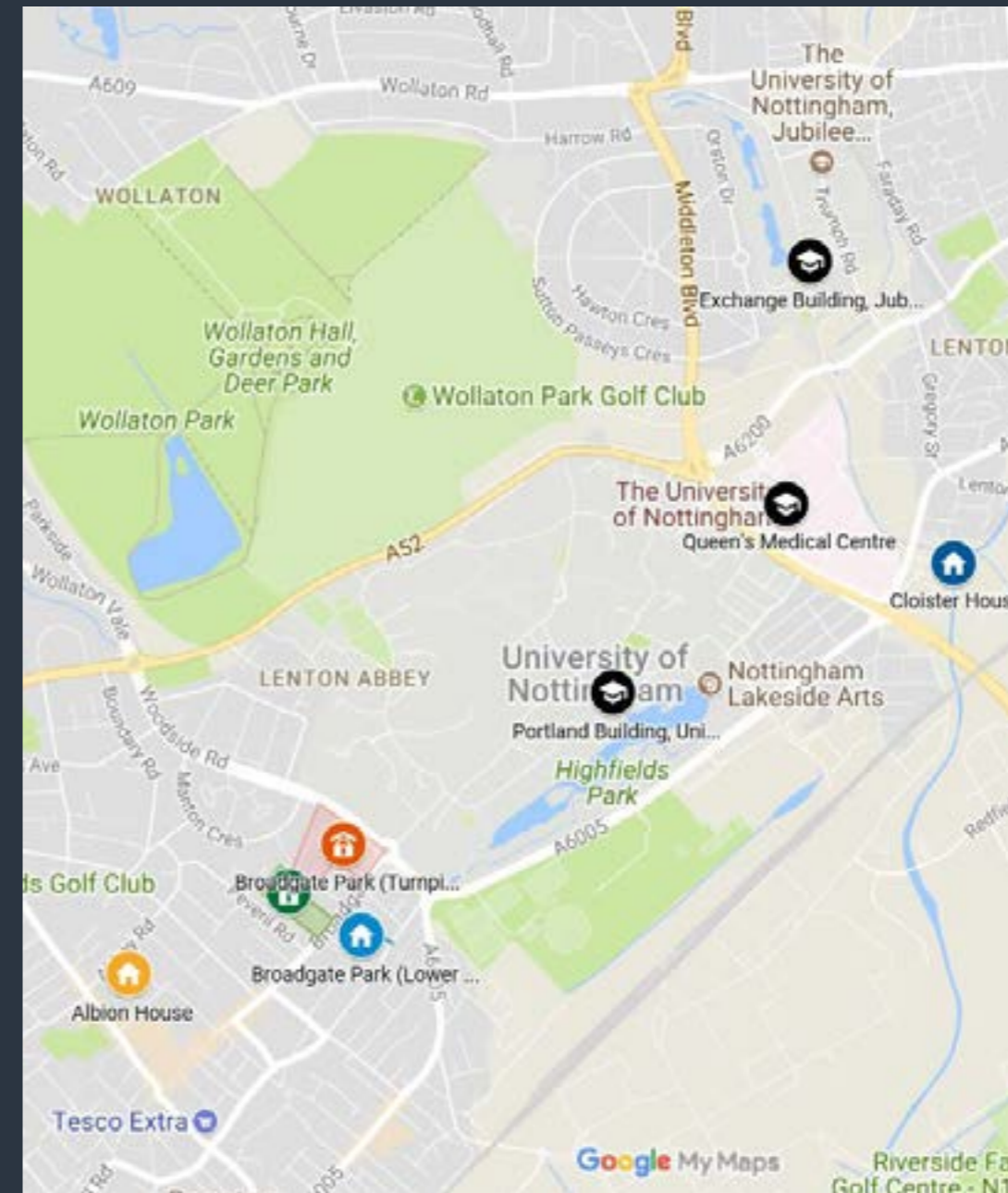

### HOTEL & B&B'S



**VIEW SHORT TERM  
ACCOMMODATION  
IN NOTTINGHAM**

**What's  
happening  
at your halls**

**Log a  
maintenance  
issue**

**Download our app**



**home at halls**

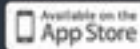

**Sign up  
to events**

**Give  
feedback**

**Follow Us - Search broadgatepark**

