

BROADGATE PARK

PARENT GUIDE 20/21



**DOWNLOAD
OUR APP**

 home at halls

BROADGATE PARK
The place to be

+44 (0)115 951 8670
broadgatepark@upp-ltd.com



University of
Nottingham
UK | CHINA | MALAYSIA

in
partnership
with



CHECKLIST

REGISTER AT THE UNIVERSITY OF NOTTINGHAM

Encourage online pre-registration.

Please follow University guidance on registering.

DOWNLOAD THE SU APP

Your son/daughter will find the most up-to-date information for all Welcome events, campus maps so they never feel lost, useful contacts if they need support and information about upcoming elections. Suitable for both Apple and android devices.

PARCEL LOCKERS AMAZON

We have an Amazon locker onsite - add this to your Amazon address book. The name of the locker is 'Vine'.

UniDrop LOCKER

All couriers are directed to use this if they are unable to get in touch with the student whilst on site. Speak to Reception for more information.

COMPLETE THE E-INDUCTION

Your son/daughter will be invited to complete their online induction prior to arrival. This will only take around 10 mins and will provide them with important information about life at Broadgate Park.

Please ensure that they choose an arrival slot once this has been complete.

WI-FI

Our internet is provided by Glide. We advise all new arrivals register for the internet access prior to arrival.

BROADGATE

ALBION HOUSE

CLOISTER HOUSE

ENDSLEIGH INSURANCE

Included in the rent is basic contents insurance, please check the cover is adequate for all personal items.

You can check the cover here and search UPP (Broadgate Park)

PAYMENTS AND KEY DATES

Term 1 and deposit due
3rd Sept 20

Term 2 due
18th Jan 21

Term 3 due
14th May 21

All payments must be made direct to the University via the [MyNottingham portal](#) or by bank transfer using the information given in this link - [University payment information](#)

If reliant upon a UK student loan please note that the damage deposit of £250.00 plus a £250.00 rent pre-payment must be paid by 3rd September 2020.

Please [email us](#) to confirm when the payments have been made towards the rent and deposit.

LICENCE DATES

Undergraduates - 18th September 2020* - 23rd July 2021

*Arrival slots may vary to this date

Postgraduates - 18th September 2020* - 10th September 2021

*Arrival slots may vary to this date

Semester 1 - 19th September 2020* - 22nd January 2021

*Arrival slots may vary to this date

Semester 2 - 24th January 2021 - 19th June 2021

ROOM DETAILS

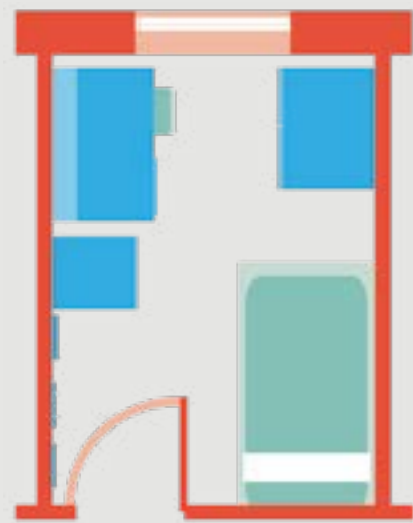

Please note room layouts may vary

STANDARD BEDROOM/ LARGE STANDARD BEDROOM

Items in the bedroom

Bed
Curtains
Wardrobe
Desk & Chair
Wi-Fi & Data Point
Mirror

Items in the communal space

Toaster
Fridge
Freezer
Iron & Board
Hob
Microwave

***Corridor,
kitchen and
bathroom
cleaned once
a week**

Standard Bedroom - Single bed (Approx. 90 x 190 cm)

Large Standard Bedroom - Small double bed (Approx. 120 x 190 cm)

Take a tour of our Standard Bedroom Flat

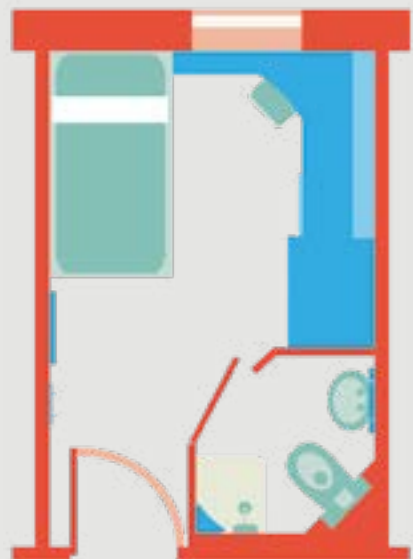

Please note room layouts may vary

ENSUITE BEDROOM/ LARGE ENSUITE BEDROOM

Items in the bedroom

Bed
Curtains
Wardrobe
Desk & Chair
Wi-Fi & Data Point
Mirror

Items in the communal space

Toaster
Fridge
Freezer
Iron & Board
Hob
Microwave

***Corridor
and kitchen
cleaned once
a week**

Ensuite Bedroom - Single bed (Approx. 90 x 190 cm)

Large Ensuite Bedroom - Small double bed (Approx. 120 x 190 cm)

Take a tour of our Ensuite Flat

*Cleaning in line with Government guidelines. Subject to change.

ROOM DETAILS



Please note room layouts may vary

ENSUITE STUDIO/ LARGE ENSUITE STUDIO

Bed
Curtains
Wardrobe
Desk & Chair
Wi-Fi & Data Point
Mirror
Kettle

Fridge with chiller compartment
Hob
Microwave combination oven
Dedicated ironing room (within the block)

***Corridor
cleaned once
a week**

Ensuite Studio - Single bed (Approx. 90 x 190 cm)

Large Ensuite Studio -
Small double bed (Approx. 120 x 190 cm)

Take a tour of our Ensuite Studio Flat

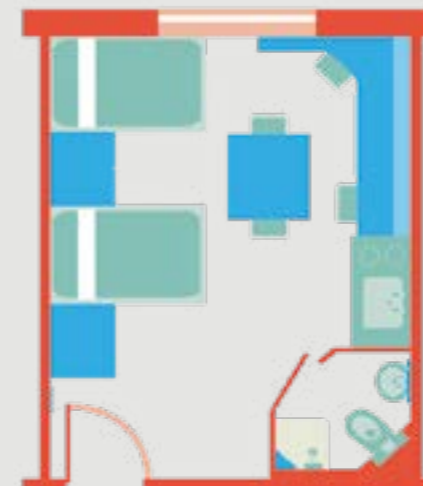

Please note room layouts may vary

TWIN ENSUITE STUDIO/ LARGE TWIN ENSUITE STUDIO

Bed
Curtains
Wardrobe
Desk & Chair
Wi-Fi & Data Point
Mirror
Kettle

Fridge with chiller compartment
Hob
Microwave combination oven
Dedicated ironing room (within the block)

***Corridor
cleaned once
a week**

Twin Ensuite Studio -
2x Single bed (Approx. 90 x 190cm)

Large Twin Ensuite Studio -
2x Single bed (90 x 190cm)

Take a tour of our Twin Ensuite Studio Flat

WHAT TO BRING

BEDDING AND TOWELS

Bed linen (fitted base sheet, duvet, pillows and covers)
Hand Towel/Bath towel

COOKING EQUIPMENT

Crockery (plate, bowl, mug and a glass)
Sauce pan/frying pan
Baking tray
Tea towels
Cutlery and cooking utensils (wooden spoon etc.)

OTHER ESSENTIALS

Clothes hangers (these are not provided)
Warm coat, hat, gloves and a scarf
Umbrella
Toilet paper

BEDDING PACKS

Bedding packs can be ordered online. The pack consists of a hand towel, bath towel, fitted base sheet, duvet, pillow and covers.

Bedding packs
£25

VIEW OUR WHAT TO BRING VIDEO



PROHIBITED ITEMS

ANIMALS

FAIRY LIGHTS

Unless battery operated

CANDLES/INCENSE/JOSS STICKS

Or any items with a naked/covered flame

CHIP PANS & DEEP FAT FRYERS

These are a high risk fire hazard

CONVECTOR/FAN/HALOGEN HEATERS

Oil filled heaters are authorised

OVER DOOR HANGERS

Do not use on the room door due to health and safety

MINI FRIDGES

Medical fridges are available, please contact broadgatepark@upp-ltd.com to arrange, subject to condition

Room visits are carried out twice a year by the Residence Team. If prohibited items are found during visits, this will be raised as a concern and a course of action will be agreed upon.

If your son/daughter wish to bring a rice cooker please ensure this is kept **ONLY** in the communal kitchen (studio excluded)

The above list is not exhaustive and provided as a guide only. If you have any concerns about an item please contact Reception.

USING THE SPACE SAFELY

VIEW OUR VIDEO ON SAFE USE OF UK POWER OUTLETS



PREVENTION MEASURES

For safety reasons, our detection devices are highly sensitive and can be triggered by smoke, excessive steam or even aerosols. Close bathroom doors when showering. Never leave cooking unattended and always ventilate the area with the cooker hood and open windows. Smoking, vaping, naked or covered flames and deep fat frying are not permitted.

GENERAL SAFETY TIPS

- Doors should never be propped open (including fire doors).
- Keys should always be carried about the person to keep them safe. Keys should never be given to anyone else.
- Encourage awareness of strangers on the premises. If they are not sure who someone is they should ask them or alert the staff.
- Doors should always be locked when going out and should be kept closed at all times even if just nipping to the kitchen/bathroom.
- If residents see anything suspicious they should report it to staff as soon as possible.
- If the room is at ground level or easily accessible from the ground, remind your son/daughter to shut the window before they go out. Windows will only tilt outwards and should not open fully.

FIRE SAFETY

NEED TO KNOW INFORMATION



IDENTIFY THE FIRE ASSEMBLY POINT

(these are displayed in the flat)



IF A FIRE IS DISCOVERED
DO NOT USE FIRE
EXTINGUISHERS/BLANKETS.



FIRE
BLANKET



Your son/daughter should close all doors behind them, break the glass on their nearest call point and evacuate the building.

IT'S A CRIMINAL OFFENCE TO TAMPER WITH FIRE EQUIPMENT AND STUDENTS WILL BE FINED FOR MISUSE, AS WELL AS BEING CHARGED FOR REPLACING EQUIPMENT. DO NOT REMOVE THE TAGS FROM THE FIRE EXTINGUISHERS AND DETECTORS MUST NOT BE COVERED UNDER ANY CIRCUMSTANCE.



FIRE DOORS SHOULD REMAIN CLOSED AT ALL TIMES AND SHOULD NOT BE WEDGED OPEN, DOING SO WILL POSE A SERIOUS SECURITY AND FIRE RISK.

SHOULD ANYONE BECOME AWARE OF A FIRE OR A HAZARD THAT COULD DEVELOP INTO A FIRE THEY SHOULD CONTACT RECEPTION IMMEDIATELY.



FIRE ALARM TEST



EVERY THURSDAY

If alarm sounds for longer than 60 seconds, residents should proceed to their assembly point

ONSITE FACILITIES

LEVEL 1

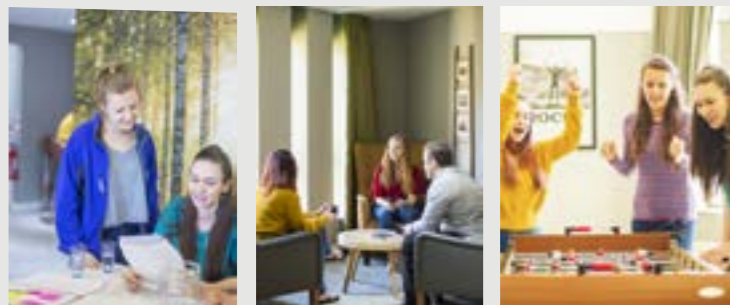

We will let your son/daughter know when these spaces are available to use.

Level 1 was developed with students in mind creating The Lounge and The Library spaces.

The Lounge allows students to relax and unwind with access to gaming stations, table football and comfy seating around our projector screen, whilst The Library has study areas for both group and individual work.

PARKING



Parking permits are available for £300 per year.

[Click here to download an application.](#)

Fixed penalty notices of £75 will be applied to non-permit holders or failing to display a permit.

(Parking regulations do not apply during intake)
ALL visitors must report to the Reception.

LAUNDRY



The Reception laundry and Albion House laundry rooms operate on the circuit laundry app. Our other laundries across the site operate on a cash basis. All laundries are £2 to wash and £1 to dry-exact change is required in the cash operated laundries.

POST AND PARCELS

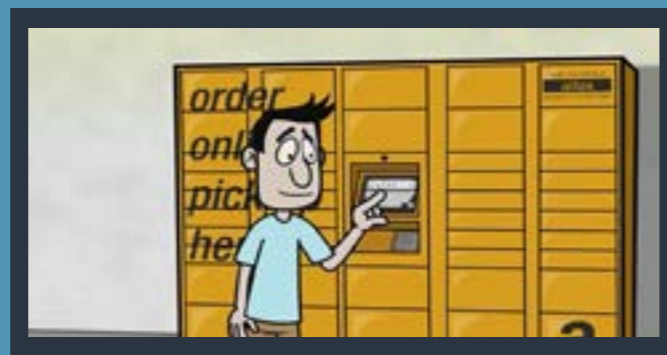

Each flat has a shared mailbox which Royal Mail can access for delivery of letters and small parcels. Encourage your son/daughter to add a contact number for packages so delivery drivers can contact them.

For delivery to our Reception Amazon locker, add 'Vine' to the address book. If the UniDrop multi courier parcel locker has been used for deliveries the student will be notified by text.

THE LOCAL AREA

ALBION HOUSE AND BROADGATE PARK

Albion House and Broadgate Park are both located in the lively Nottingham suburb of Beeston. As well as using excellent local facilities, the following links provide a short insight into the local area.

ALBION HOUSE

BROADGATE PARK

SUPERMARKETS

Tesco Extra (Beeston) NG9 2WJ

Mon – Sat 6am - 12am

Sun 11am - 5pm

0.4 miles from Albion

0.9 miles from Broadgate

Sainsbury's (Beeston) NG9 2LA

Mon – Fri 8am - 10pm

Sat 7am - 10pm

Sun 10am - 4pm

0.1 miles from Albion

0.6 miles from Broadgate

Lidl (Beeston) NG9 2NG

Mon – Sat 8am - 10pm

Sun 10am - 4pm

0.1 miles from Albion

0.8 miles from Broadgate

Co-op (Beeston) NG9 2GJ

Mon – Sun 7am - 8pm

0.7 miles from Albion

0.2 miles from Broadgate

TRANSPORT

DG Cars

0115 9500 500

dgcars.co.uk



Albion House and Broadgate Park are in close proximity to a number of major bus routes heading into the city and Beeston. The tram is also easily accessible.

Uon Hopper Buses

[UoN Hopper Bus Information](#)

Trent Barton's Indigo service

trentbarton.co.uk/services/indigo

Nottingham City Transport's 36 service

goo.gl/GP0zJe

Nottingham Express Transit's Tram service

thetram.net/

THE LOCAL AREA

CLOISTER HOUSE

USEFUL INFORMATION

Dunkirk is home to Queens Medical Centre, Showcase Cinema and a great student pub, The Johnson Arms. Cloister House is in the heart of this community favoured for pubs, takeaways and the Redfield Way entertainment park. The following link provides a short insight to the local area.

CLOISTER HOUSE

SUPERMARKETS

Tesco Express (Castle Boulevard)
NG7 1SA
Mon – Sun 7am - 11pm
0.5 miles from Cloister House

Sainsbury's (Castle Marina)
NG7 1GX
Mon - Sat 7am - 11pm
Sun 10am - 4pm
0.9 miles from Cloister House

SPAR
NG7 2JW
Mon - Sun 6am - 10pm
0.4 mile from Cloiser House

TRANSPORT

DG Cars
0115 9500 500
dgcars.co.uk



Cloister House is in close proximity to both the major bus routes and tram line.

UoN Hopper Buses
[UoN Hopper Bus Information](#)

Trent Barton's Skylink service
trentbarton.co.uk/services/skylinknottingham

Nottingham City Transport's 34 service
goo.gl/6cajX9

Nottingham Express Transit's Tram service
thetram.net/

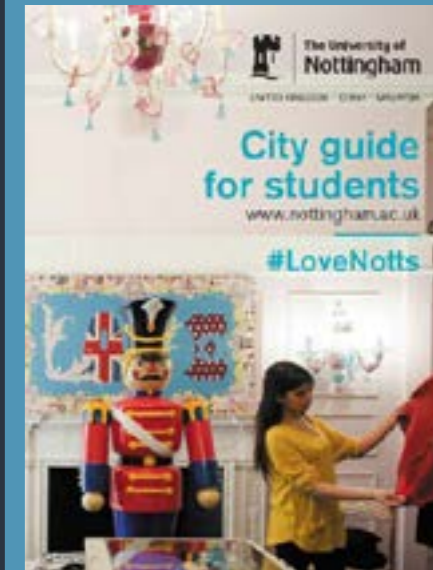
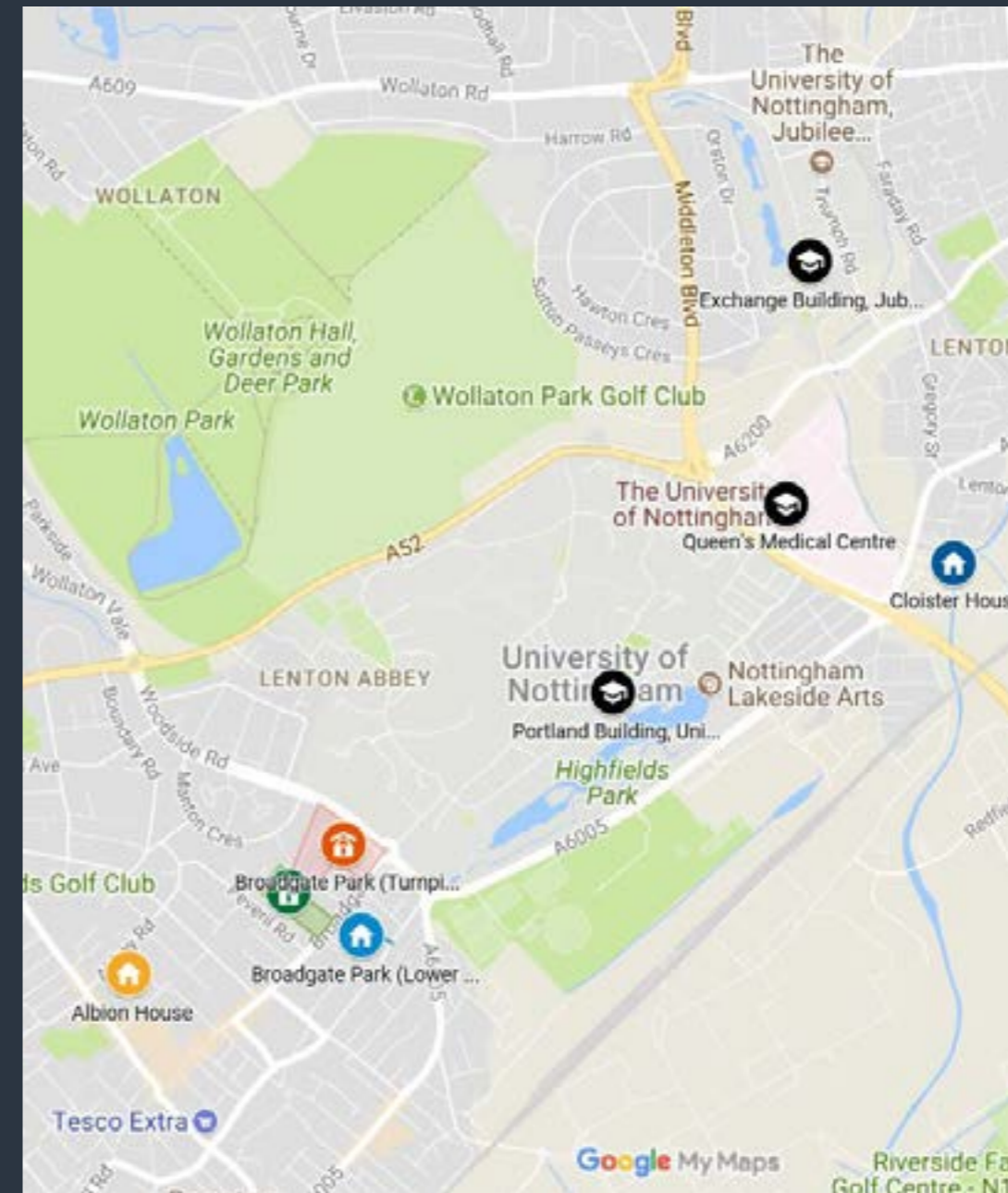

HOTEL & B&B'S



**VIEW SHORT TERM
ACCOMMODATION
IN NOTTINGHAM**

OUR MESSAGE TO YOU

We know how important the residential experience is to your son/daughter's time at university and we are working with the University to ensure the accommodation is ready to occupy in September.

Our teams are following the latest Government guidance and your son/daughter should observe social distancing protocols to protect themselves and others.

We have enhanced our cleaning practices in all communal areas and we will communicate this upon arrival about what this means for your son/daughter.

Whilst the academic year 2020/21 will be a different experience, we are doing our best to make it as great as possible, and one where students continue to thrive.

There will be extra health and wellbeing guidance/expectations and it is all of our responsibility to understand and follow these.

If any resident develops COVID-19 symptoms, we will ensure the student and their household are supported and have access to the latest Government advice.

Submit
your room
inventory

What's
happening
at your halls

Download our app



Log a
maintenance
issue

Give
feedback

Follow Us - Search broadgatepark

