

BROADGATE PARK

PARENT GUIDE 18/19



BROADGATE PARK
The place to be

+44 (0)115 951 8670
broadgatepark@upp-ltd.com



University of Nottingham
UK | CHINA | MALAYSIA

in
partnership
with



CHECKLIST

REGISTER AT THE UNIVERSITY OF NOTTINGHAM

Encourage online pre-registration.

All new full-time students must also confirm their attendance in person as per University instruction.

DOWNLOAD THE SU APP

Your son/daughter will find the most up-to-date information for all Welcome events, campus maps so they never feel lost, useful contacts if they need support and information about upcoming elections. Suitable for both Apple and android devices.

ADD AMAZON LOCKER

We have an Amazon locker onsite - remind your family member to add this to their Amazon address book.

The name of the locker is 'Vine'.

COMPLETE THE E-INDUCTION

Your son/daughter must complete their online induction prior to arrival. This will only take approx.10 mins and will provide them with important information about life at Broadgate Park.

WI-FI

Our internet is provided by Glide. We advise all new arrivals register for the internet access prior to arrival.

BROADGATE

ALBION HOUSE

CLOISTER HOUSE

ENDSLEIGH INSURANCE

Included in the rent is basic contents insurance, please check the cover is adequate for all personal items.

You can check the cover by searching UPP (Broadgate Park)

PAYMENTS AND KEY DATES

Term 1 and deposit due
10th Sept 18

Term 2 due
21st Jan 19

Term 3 due
20th May 19

All payments must be made direct to the University via the student portal or by bank transfer.
University payment information

If reliant upon a UK student loan please note that the damage deposit of £250.00 plus a £250.00 rent pre-payment must be paid by 10th September 2018. Please notify student account services on sas@nottingham.ac.uk with the student finance breakdown to verify that your son/daughter qualify for the loan payment plan.

LICENCE DATES

Undergraduates - 21st September 2018 - 26th July 2019

Postgraduates - 21st September 2018 - 13th September 2019

Semester 1 - 22nd September 2018 - 25th January 2019

Semester 2 - 27th January 2019 - 22nd June 2019

ROOM DETAILS

STANDARD BEDROOM/ LARGE STANDARD BEDROOM

Items in the bedroom

Bed
Curtains
Wardrobe
Desk & Chair
Wi-Fi & Date Point
Mirror

Items in the communal space

Toaster
Fridge
Freezer
Iron & Board
Hob
Microwave

Corridor,
kitchen and
bathroom
cleaned once
a week

Standard Bedroom - Single bed (Approx. 90 x 190 cm)

Large Standard Bedroom - Small double bed (Approx. 120 x 190 cm)

[Take a tour of our Standard Bedroom Flat](#)

ENSUITE BEDROOM/ LARGE ENSUITE BEDROOM

Items in the bedroom

Bed
Curtains
Wardrobe
Desk & Chair
Wi-Fi & Date Point
Mirror

Items in the communal space

Toaster
Fridge
Freezer
Iron & Board
Hob
Microwave

Corridor
and kitchen
cleaned once
a week

Ensuite Bedroom - Single bed (Approx. 90 x 190 cm)

Large Ensuite Bedroom - Small double bed (Approx. 120 x 190 cm)

[Take a tour of our Ensuite Flat](#)

ROOM DETAILS

ENSUITE STUDIO/ LARGE ENSUITE STUDIO

Bed
Curtains
Wardrobe
Desk & Chair
Wi-Fi & Date Point
Mirror
Kettle

Fridge with chiller compartment
Hob
Microwave combination oven
Dedicated ironing room (within the block)

Corridor
cleaned once
a week

Ensuite Studio - Single bed (Approx. 90 x 190 cm)

Large Ensuite Studio -
Small double bed (Approx. 120 x 190 cm)

[Take a tour of our Ensuite Studio Flat](#)

TWIN ENSUITE STUDIO/ LARGE TWIN ENSUITE STUDIO

Bed
Curtains
Wardrobe
Desk & Chair
Wi-Fi & Date Point
Mirror
Kettle

Fridge with chiller compartment
Hob
Microwave combination oven
Dedicated ironing room (within the block)

Corridor
cleaned once
a week

Twin Ensuite Studio -
2x Single bed (Approx. 90 x 190cm)

Large Twin Ensuite Studio -
2x Single bed (90 x 190cm)

[Take a tour of our Twin Ensuite Studio Flat](#)

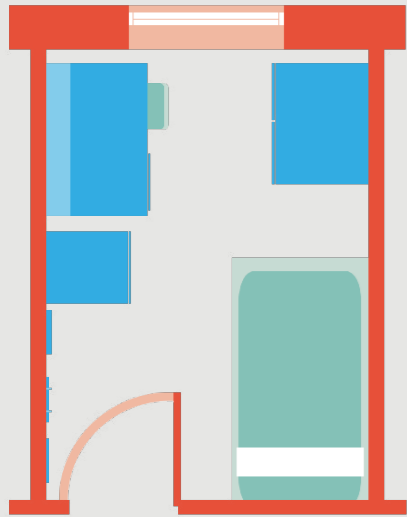

Please note room layouts may vary

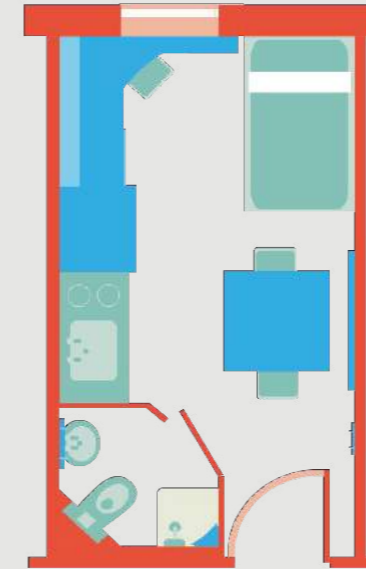

Please note room layouts may vary

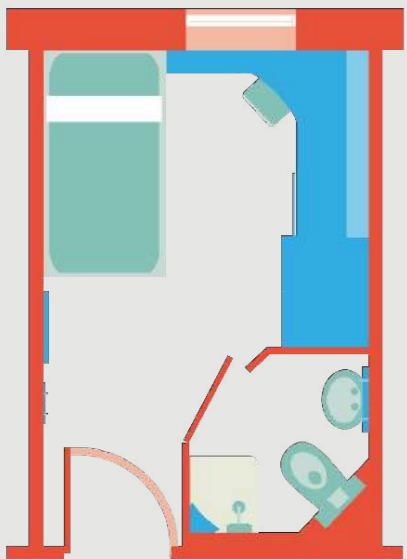

Please note room layouts may vary

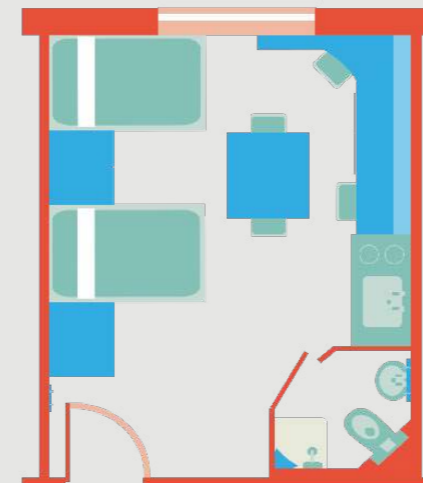

Please note room layouts may vary

WHAT TO BRING

BEDDING AND TOWELS

Bed linen (fitted base sheet, duvet, pillows and covers)
Hand Towel/Bath towel

COOKING EQUIPMENT

Crockery (plate, bowl, mug and a glass)
Sauce pan/frying pan
Baking tray
Tea towels
Cutlery and cooking utensils (wooden spoon etc.)

OTHER ESSENTIALS

Clothes hangers (these are not provided)
Warm coat, hat, gloves and a scarf
Umbrella
Toilet paper

BEDDING PACKS

Bedding packs can be purchased at Reception on arrival. The pack consists of a hand towel, bath towel, fitted base sheet, duvet, pillow and covers.

£25
Single

£35
Double

VIEW OUR WHAT TO BRING VIDEO



PROHIBITED ITEMS

ANIMALS

FAIRY LIGHTS

Unless battery operated

CANDLES/INCENSE/JOSS STICKS

Or any items with a naked/covered flame

CHIP PANS & DEEP FAT FRYERS

These are a high risk fire hazard

CONVECTOR/FAN/HALOGEN HEATERS

Oil fan heaters are authorised

MINI FRIDGES

Medical fridges are available, please contact broadgateparklettings@upp-ltd.com to arrange, subject to condition

The above list is not exhaustive and provided as a guide only. If you have any concerns about an item please contact Reception.

Room visits are carried out twice a year by the Residence Team. If prohibited items are found during visits, this will be raised as a concern and a course of action will be agreed upon.

If your son/daughter wish to bring a rice cooker please ensure this is kept ONLY in the communal kitchen.

USING THE SPACE SAFELY

SAFE ELECTRICALS



VIEW OUR VIDEO
ON SAFE USE OF
UK POWER
OUTLETS

GENERAL SAFETY TIPS

- Doors should never be propped open (including fire doors).
- Keys should always be carried about the person to keep them safe. Keys should never be given to anyone else.
- Encourage awareness of strangers on the premises. If they are not sure who someone is they should ask them or alert the staff.
- Doors should always be locked when going out and should be kept closed at all times even if just nipping to the kitchen/bathroom.
- If residents see anything suspicious they should report it to staff as soon as possible.
- If the room is at ground level or easily accessible from the ground, remind your son/daughter to shut the window before they go out. Windows will only tilt outwards and should not open fully.

PREVENTION MEASURES

For safety reasons, our detection devices are highly sensitive and can be triggered by smoke, excessive steam or even aerosols. Close bathroom doors when showering. Never leave cooking unattended and always ventilate the area with the cooker hood and open windows. Smoking, vaping, naked or covered flames and deep fat frying are not permitted.

FIRE SAFETY

NEED TO KNOW INFORMATION



IDENTIFY THE FIRE ASSEMBLY POINT

(these are displayed in the flat)



IF A FIRE IS DISCOVERED
DO NOT USE FIRE
EXTINGUISHERS/BLANKETS.



FIRE
BLANKET



YOUR SON/DAUGHTER SHOULD
CLOSE ALL DOORS BEHIND THEM,
BREAK THE GLASS ON THEIR
NEAREST CALL POINT AND
EVACUATE THE BUILDING.

IT'S A CRIMINAL OFFENCE TO TAMPER WITH FIRE
EQUIPMENT AND STUDENTS WILL BE FINED FOR
MISUSE, AS WELL AS BEING CHARGED FOR REPLACING
EQUIPMENT. DO NOT REMOVE THE TAGS FROM THE FIRE
EXTINGUISHERS AND DETECTORS MUST NOT BE
COVERED UNDER ANY CIRCUMSTANCE.



FIRE DOORS SHOULD
REMAIN CLOSED AT
ALL TIMES AND
SHOULD NOT BE
WEDGED OPEN,
DOING SO WILL POSE
A SERIOUS SECURITY
AND FIRE RISK.

SHOULD ANYONE
BECOME AWARE
OF A FIRE OR
A HAZARD THAT
COULD DEVELOP INTO
A FIRE THEY SHOULD
CONTACT RECEPTION
IMMEDIATELY.



FIRE ALARM TEST



EVERY THURSDAY

IF ALARM SOUNDS FOR LONGER THAN
60 SECONDS, RESIDENTS SHOULD
PROCEED TO THEIR ASSEMBLY POINT

ONSITE FACILITIES

LEVEL 1



Level 1 was specifically designed with our students in mind consisting of The Lounge and The Library.

The Lounge is a space that allows our students to relax and unwind with access to a couple of gaming stations, table football and comfy beanbag seating in front of a projector screen, whilst The Library has several study areas for both group and individual work.

LAUNDRY



The Reception laundry and Albion House laundry rooms operate on the circuit laundry app. Our other laundries across the site operate on a cash basis. All laundries are £2 to wash and £1 to dry-exact change is required in the cash operated laundries.

POST AND PARCELS



Each flat has a shared mailbox which Royal Mail can access for delivery of letters and small parcels. Encourage your son/daughter to include a contact number for packages so delivery drivers can contact them. For delivery to our Reception Amazon locker, add 'Vine' to the address book.

THE LOCAL AREA

ALBION HOUSE AND BROADGATE PARK

Albion House and Broadgate Park are both located in the lively Nottingham suburb of Beeston. As well as using excellent local facilities, the following links provide a short insight into the local area.

ALBION HOUSE

BROADGATE PARK

SUPERMARKETS

Tesco Extra (Beeston) NG9 2WJ
Mon – Sat 6am - 12am
Sun 11am - 5pm
0.4 miles from Albion
0.9 miles from Broadgate

Sainsbury's (Beeston) NG9 2LA
Mon – Fri 8am - 10pm
Sat 7am - 10pm
Sun 10am - 4pm
0.1 miles from Albion
0.6 miles from Broadgate

Lidl (Beeston) NG9 2NG
Mon – Sat 8am - 8pm
Sun 10am - 4pm
0.1 miles from Albion
0.8 miles from Broadgate

Co-op (Beeston) NG9 2GJ
Mon – Sun 5am - 11pm
0.7 miles from Albion
0.2 miles from Broadgate

TRANSPORT

DG Cars
0115 9500 500
dgcars.co.uk



Albion House and Broadgate Park are in close proximity to a number of major bus routes heading into the city and Beeston. The tram is also easily accessible.

Trent Barton's Indigo service
trentbarton.co.uk/services/indigo

Your Bus' Y36 service
catchyourbus.co.uk/y36/index.html

Nottingham City Transport's 36 service
goo.gl/GP0zJe

Nottingham Express Transit's Tram service
thetram.net/

THE LOCAL AREA

CLOISTER HOUSE

USEFUL INFORMATION

Dunkirk is home to Queens Medical Centre, Showcase Cinema and a great student pub, The Johnson Arms. Cloister House is in the heart of this community favoured for pubs, takeaways and the Redfield Way entertainment park. The following link provides a short insight to the local area.

CLOISTER HOUSE

SUPERMARKETS

Tesco Express (Castle Boulevard)
NG7 1SA
Mon – Sun 7am - 11pm
0.5 miles from Cloister House

Sainsbury's (Castle Marina)
NG7 1GX
Mon - Fri 7am - 11pm
Sat 7am - 10pm
Sun 10am - 4pm
0.9 miles from Cloister House

SPAR
NG7 2JW
Mon - Sun 6am - 10pm
0.4 mile from Cloiser House

TRANSPORT

DG Cars
0115 9500 500
dgcars.co.uk



Cloister House is in close proximity to both the major bus routes and tram line.

Trent Barton's Skylink service
trentbarton.co.uk/services/skylinknottingham

Your Bus' Y5 service
catchyourbus.co.uk/y5/index.html

Nottingham City Transport's 34 service
goo.gl/6cajX9

Nottingham Express Transit's Tram service
thetram.net/

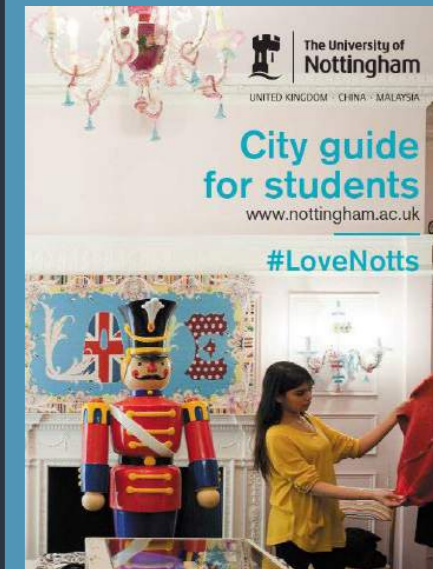
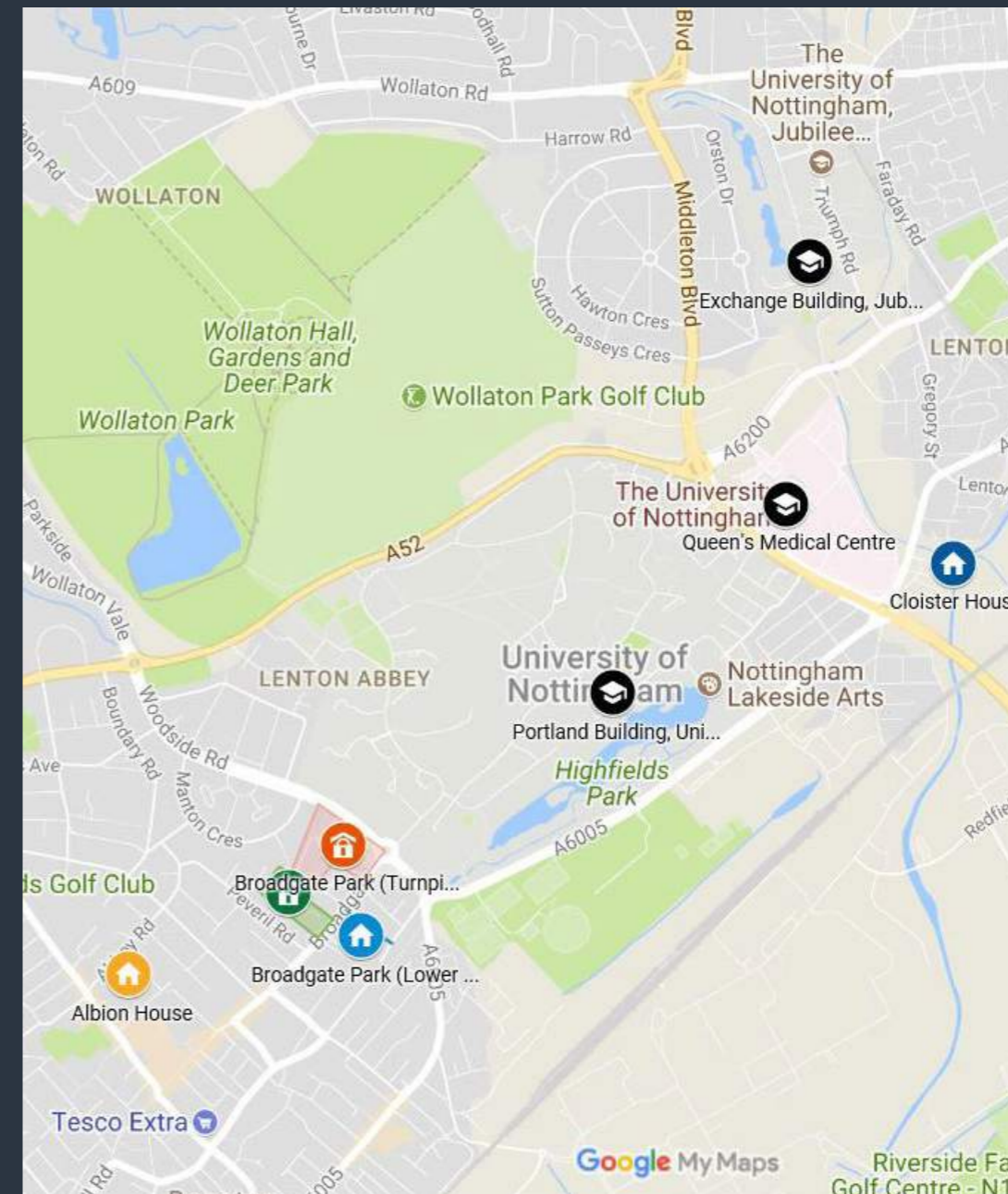

HOTEL & B&B'S



**VIEW SHORT TERM
ACCOMMODATION
IN NOTTINGHAM**

Follow Us - Search broadgatepark

