

BROADGATE PARK

STUDENT ARRIVAL GUIDE 20/21



DOWNLOAD
OUR APP

 home at halls

BROADGATE PARK
The place to be

+44 (0)115 951 8670
broadgatepark@upp-ltd.com



University of
Nottingham
UK | CHINA | MALAYSIA

in
partnership
with



YOUR CHECKLIST

REGISTER AT THE UNIVERSITY OF NOTTINGHAM

Click here to complete your online pre-registration.

Please follow University guidance on registering.

DOWNLOAD THE SU APP NOW

You'll find the most up-to-date information for all Welcome events, campus maps so you never feel lost, useful contacts if you need support and information about upcoming elections. Suitable for both Apple and android devices.

PARCEL LOCKERS AMAZON

We have an Amazon locker onsite - add this to your Amazon address book. The name of the locker is 'Vine'.

UniDrop LOCKER

All couriers are directed to use this if they are unable to get in touch with you whilst on site. Speak to Reception for more information.

COMPLETE THE E-INDUCTION

You will be invited to complete your online induction prior to your arrival. This will only take around 10 mins and will provide you with important information about life at Broadgate Park.

Please ensure that you choose your arrival slot once this has been complete.

WI-FI

Our internet is provided by Glide. We advise that you register for the internet access prior to your arrival. Click your hall below.

BROADGATE

ALBION HOUSE

CLOISTER HOUSE

ENDSLEIGH INSURANCE

Included in your rent is basic contents insurance, please check the cover is adequate for all of your personal items.

You can check your cover here and search UPP (Broadgate Park)

PAYMENTS AND KEY DATES

Term 1 and deposit due
3rd Sept 20

Term 2 due
18th Jan 21

Term 3 due
14th May 21

All payments must be made direct to the University via your [MyNottingham portal](#) or by bank transfer using the information given in this link - [University payment information](#)

If you are reliant upon a UK student loan please note that your damage deposit of £250.00 plus a £250.00 rent pre-payment must be paid by 3rd September 2020.

Please [email us](#) to confirm when you have made payments towards your rent and deposit.

LICENCE DATES

Undergraduates - 18th September 2020* - 23rd July 2021

*Arrival slots may vary to this date

Postgraduates - 18th September 2020* - 10th September 2021

*Arrival slots may vary to this date

Semester 1 - 19th September 2020* - 22nd January 2021

*Arrival slots may vary to this date

Semester 2 - 24th January 2021 - 19th June 2021

YOUR ROOM

STANDARD BEDROOM/ LARGE STANDARD BEDROOM

Items in the bedroom

Bed
Curtains
Wardrobe
Desk & Chair
Wi-Fi & Data Point
Mirror

Items in the communal space

Toaster
Fridge
Freezer
Iron & Board
Hob
Microwave

***Corridor,
kitchen and
bathroom
cleaned once
a week**

Standard Bedroom - Single bed (Approx. 90 x 190 cm)

Large Standard Bedroom - Small double bed (Approx. 120 x 190 cm)

Take a tour of our Standard Bedroom Flat

ENSUITE BEDROOM/ LARGE ENSUITE BEDROOM

Items in the bedroom

Bed
Curtains
Wardrobe
Desk & Chair
Wi-Fi & Data Point
Mirror

Items in the communal space

Toaster
Fridge
Freezer
Iron & Board
Hob
Microwave

***Corridor
and kitchen
cleaned once
a week**

Ensuite Bedroom - Single bed (Approx. 90 x 190 cm)

Large Ensuite Bedroom - Small double bed (Approx. 120 x 190 cm)

Take a tour of our Ensuite Flat

*Cleaning in line with Government guidelines. Subject to change.

YOUR ROOM

ENSUITE STUDIO/ LARGE ENSUITE STUDIO

Bed
Curtains
Wardrobe
Desk & Chair
Wi-Fi & Data Point
Mirror
Kettle

Fridge with chiller compartment
Hob
Microwave combination oven
Dedicated ironing room (within the block)

***Corridor
cleaned once
a week**

Ensuite Studio - Single bed (Approx. 90 x 190 cm)

Large Ensuite Studio -
Small double bed (Approx. 120 x 190 cm)

Take a tour of our Ensuite Studio Flat

TWIN ENSUITE STUDIO/ LARGE TWIN ENSUITE STUDIO

Bed
Curtains
Wardrobe
Desk & Chair
Wi-Fi & Data Point
Mirror
Kettle

Fridge with chiller compartment
Hob
Microwave combination oven
Dedicated ironing room (within the block)

***Corridor
cleaned once
a week**

Twin Ensuite Studio -
2x Single bed (Approx. 90 x 190cm)

Large Twin Ensuite Studio -
2x Single bed (90 x 190cm)

Take a tour of our Twin Ensuite Studio Flat

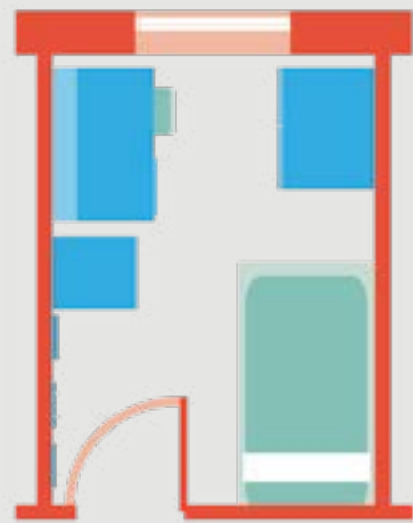

Please note room layouts may vary



Please note room layouts may vary

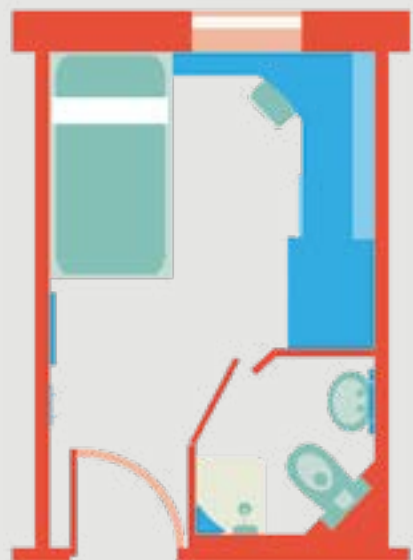

Please note room layouts may vary

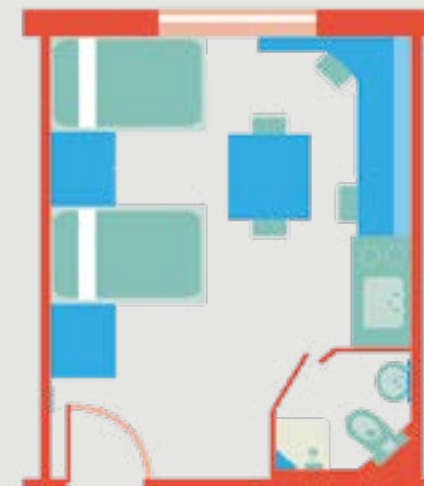

Please note room layouts may vary

WHAT TO BRING

BEDDING AND TOWELS

Bed linen (fitted base sheet, duvet, pillows and covers)
Hand Towel/Bath towel

COOKING EQUIPMENT

Crockery (plate, bowl, mug and a glass)
Sauce pan/frying pan
Baking tray
Tea towels
Cutlery and cooking utensils (wooden spoon etc.)

OTHER ESSENTIALS

Clothes hangers (these are not provided)
Warm coat, hat, gloves and a scarf
Umbrella
Toilet paper

BEDDING PACKS

Single bedding packs can be ordered online. The pack consists of a hand towel, bath towel, fitted base sheet, duvet, pillow and covers.

Bedding packs
£25

VIEW OUR WHAT TO BRING VIDEO



PROHIBITED ITEMS

ANIMALS

FAIRY LIGHTS

Unless battery operated

CANDLES/INCENSE/JOSS STICKS

Or any items with a naked/covered flame

CHIP PANS & DEEP FAT FRYERS

These are a high risk fire hazard

CONVECTOR/FAN/HALOGEN HEATERS

Oil filled heaters are authorised

OVER DOOR HANGERS

Do not use on your room door due to health and safety

MINI FRIDGES

Medical fridges are available, please contact broadgateparklettings@upp-ltd.com to arrange, subject to condition

Room visits are carried out twice a year by the Residence Team. If prohibited items are found during visits, this will be raised as a concern and a course of action will be agreed upon.

If you wish to bring a rice cooker please ensure this is kept **ONLY** in your communal kitchen (studio excluded).

The above list is not exhaustive and provided as a guide only. If you have any concerns about an item please contact Reception.

USING YOUR SPACE SAFELY

VIEW OUR VIDEO ON SAFE USE OF UK POWER OUTLETS



PREVENTION MEASURES

For safety reasons, our detection devices are highly sensitive and can be triggered by smoke, excessive steam or even aerosols. Close bathroom doors when showering. Never leave cooking unattended and always ventilate the area with the cooker hood and open windows. Smoking, vaping, naked or covered flames and deep fat frying are not permitted.

GENERAL SAFETY TIPS

- Don't prop doors open (including fire doors).
- Always carry your keys and keep them safe. Never give your keys to anyone else.
- Be aware of strangers on the premises. If you're not sure who someone is, ask them or alert the staff.
- Always lock your door when you're going out and keep it closed at all times even if you are just nipping to the kitchen/bathroom.
- If you see anything suspicious, report it to staff as soon as possible.
- If your room is at ground level or easily accessible from the ground, make sure your windows are shut before you go out. Windows will only tilt outwards and should not open fully.

FIRE SAFETY

WHAT YOU NEED TO KNOW



IDENTIFY YOUR FIRE ASSEMBLY POINT

(these are displayed in your flat)



IF YOU DISCOVER A FIRE
DO NOT USE FIRE
EXTINGUISHERS/BLANKETS.



FIRE
BLANKET



Close all doors behind you, break the glass on your nearest call point and evacuate the building.

IT'S A CRIMINAL OFFENCE TO TAMPER WITH FIRE EQUIPMENT AND YOU WILL BE FINED FOR MISUSE, AS WELL AS BEING CHARGED FOR REPLACING EQUIPMENT. DO NOT REMOVE THE TAGS FROM THE FIRE EXTINGUISHERS AND DETECTORS MUST NOT BE COVERED UNDER ANY CIRCUMSTANCE.



FIRE DOORS SHOULD REMAIN CLOSED AT ALL TIMES AND SHOULD NOT BE WEDGED OPEN, DOING SO WILL POSE A SERIOUS SECURITY AND FIRE RISK.

SHOULD YOU BECOME AWARE OF A FIRE OR A HAZARD THAT COULD DEVELOP INTO A FIRE, PLEASE CONTACT RECEPTION IMMEDIATELY.



FIRE ALARM TEST



EVERY THURSDAY

If alarm sounds for longer than 60 seconds, proceed to your assembly point.

ONSITE FACILITIES

LEVEL 1



We will let you know when these spaces are available for you to use.

Level 1 was developed with students in mind creating The Lounge and The Library spaces.

The Lounge allows students to relax and unwind with access to a gaming stations, table football and comfy seating around our projector screen, whilst The Library has study areas for both group and individual work.

PARKING



Parking permits are available for £300 per year.

Click here to download an application.

Fixed penalty notices of £75 will be applied to non-permit holders or failing to display a permit.

(Parking regulations do not apply during intake)

ALL visitors must report to the Reception.

LAUNDRY



The Reception laundry and Albion House laundry rooms operate on the circuit laundry app. Our other laundries across the site operate on a cash basis. All laundries are £2 to wash and £1 to dry-exact change is required in the cash operated laundries.

POST AND PARCELS



Each flat has a shared mailbox which Royal Mail can access for delivery of letters and small parcels. Always include a contact number for packages so delivery drivers can contact you.

For delivery to our Reception Amazon locker, add 'Vine' to your address book. If the UniDrop multi courier parcel locker has been used for your deliveries you will be notified by text.

THE LOCAL AREA

ALBION HOUSE AND BROADGATE PARK

Albion House and Broadgate Park are both located in the lively Nottingham suburb of Beeston. As well as using excellent local facilities you may want to head into the city or find the quickest route to campus. The following links provide a short insight into your local area.

ALBION HOUSE

BROADGATE PARK

SUPERMARKETS

Tesco Extra (Beeston) NG9 2WJ

Mon – Sat 6am - 12am

Sun 11am - 5pm

0.4 miles from Albion

0.9 miles from Broadgate

Sainsbury's (Beeston) NG9 2LA

Mon – Fri 8am - 10pm

Sat 7am - 10pm

Sun 10am - 4pm

0.1 miles from Albion

0.6 miles from Broadgate

Lidl (Beeston) NG9 2NG

Mon – Sat 8am - 10pm

Sun 10am - 4pm

0.1 miles from Albion

0.8 miles from Broadgate

Co-op (Beeston) NG9 2GJ

Mon – Sun 7am - 8pm

0.7 miles from Albion

0.2 miles from Broadgate

TRANSPORT

DG Cars

0115 9500 500

dgcars.co.uk



Albion House and Broadgate Park are in close proximity to a number of major bus routes heading into the city and Beeston. The tram is also easily accessible.

UoN Hopper Buses

[UoN Hopper Bus Information](#)

Trent Barton's Indigo service

trentbarton.co.uk/services/indigo

Nottingham City Transport's 36 service

goo.gl/GP0zJe

Nottingham Express Transit's Tram service

thetram.net/

THE LOCAL AREA

CLOISTER HOUSE

Welcome to Dunkirk, home to Queens Medical Centre, Showcase Cinema and a great student pub, The Johnson Arms. Cloister House is in the heart of this community favoured for pubs, takeaways and the Redfield Way entertainment park. The following link provides a short insight to your local area.

CLOISTER HOUSE

SUPERMARKETS

Tesco Express (Castle Boulevard)
NG7 1SA
Mon – Sun 7am - 11pm
0.5 miles from Cloister House

Sainsbury's (Castle Marina)
NG7 1GX
Mon - Sat 7am - 10pm
Sun 10am - 4pm
0.9 miles from Cloister House

SPAR
NG7 2JW
Mon -Sun 6am - 10pm
0.4 mile from Cloiser House

TRANSPORT

DG Cars
0115 9500 500
dgcars.co.uk



Cloister House is in close proximity to both the major bus routes and tram line.

UoN Hopper Buses
[UoN Hopper Bus Information](#)

Trent Barton's Skylink service
trentbarton.co.uk/services/skylinknottingham

Nottingham City Transport's 34 service
goo.gl/6cajX9

Nottingham Express Transit's Tram service
thetram.net/

USEFUL INFORMATION

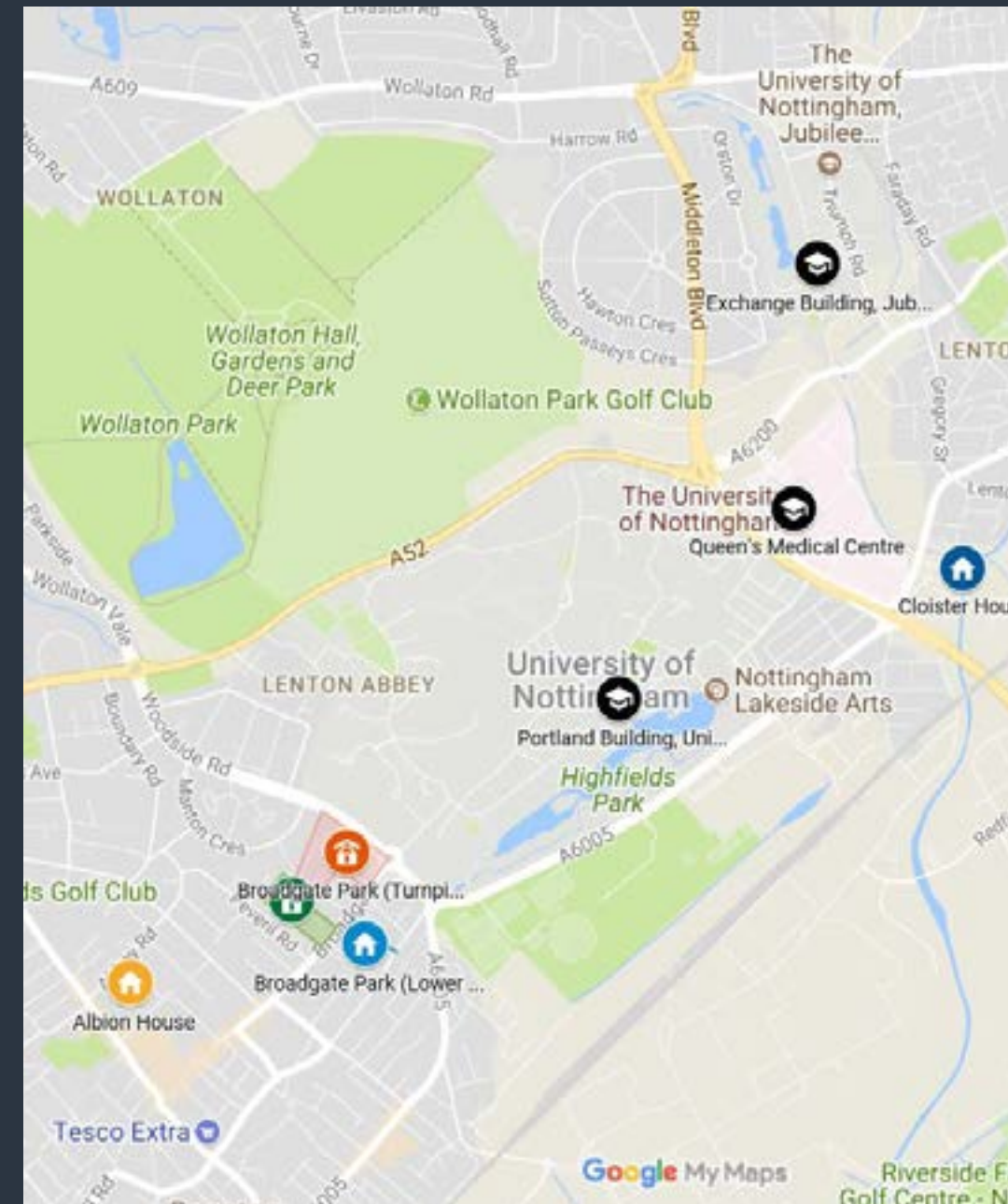

HOTEL & B&B'S



VIEW SHORT TERM
ACCOMMODATION
IN NOTTINGHAM

OUR MESSAGE TO YOU

We know how important the residential experience is to your time at university and we are working with the University to ensure your accommodation is ready to occupy in September.

Our teams are following the latest Government guidance and you should observe social distancing protocols to protect yourself and others.

We have enhanced our cleaning practices in all communal areas and we will communicate with you upon arrival about what this means for you.

Whilst the academic year 2020/21 will be a different experience, we are doing our best to make it as great as possible, and one where students continue to thrive.

There will be extra health and wellbeing guidance/expectations and it is all of our responsibility to understand and follow these.

If any resident develops COVID-19 symptoms, we will ensure the student and their household are supported and have access to the latest Government advice.

Submit
your room
inventory

What's
happening
at your halls

Download our app



home at halls



Log a
maintenance
issue

Give
feedback

Follow Us - Search broadgatepark

