

# BROADGATE PARK

## STUDENT ARRIVAL GUIDE 23/24



**BROADGATE PARK**  
The place to be

+44 (0)115 951 8670  
[accommodationnottingham@upp-ltd.com](mailto:accommodationnottingham@upp-ltd.com)



University of  
Nottingham  
UK | CHINA | MALAYSIA

in  
partnership  
with



# YOUR CHECKLIST

## REGISTER AT THE UNIVERSITY OF NOTTINGHAM

Click [here](#) to complete your online pre-registration.

Please follow University guidance on registering.

## RESIDENTIAL EXPERIENCE TEAM (ResX)

Keep an eye out for the ResX Team who provide support and deliver events and activities to join in starting from welcome weekend and through the year! The courtyard is where they are based every evening 6-10pm. Follow them on @Uonresx to keep up to date

## PARCEL LOCKERS

AMAZON  
Search NG9 2RX to find Broadgate Park locker and add this to your address book.

### UniDrop LOCKER

All couriers are directed to use this if they are unable to get in touch with you whilst on site. Speak to Reception for more information.

## COMPLETE THE E-INDUCTION

You will be invited to complete your online induction prior to your arrival. This will only take around 10 mins and will provide you with important information about life at Broadgate Park.

Please ensure that you choose your arrival slot once this has been complete.

## WI-FI

On arrival you will need to view available wireless networks and click on 'Glide'. This will grant you full internet access.

You do not need to register for your internet before you arrive.

## ENDSLEIGH INSURANCE

Included in your rent is basic contents insurance.

You can check and confirm your cover [here](#) and search UPP (Broadgate Park)

# PAYMENTS AND KEY DATES

Term 1 and  
deposit due  
**14th Sept  
23**

Term 2  
due  
**17th Jan  
24**

Term 3  
due  
**1st May  
24**

All payments must be made direct to the University via your [MyNottinghamHub](#). Please note that your accommodation invoices will not be visible until early September, however you can make payment without these. Alternative payment methods can be found [here](#).

If you are reliant upon a UK student loan please note that your £250 damage deposit plus a £250 initial rent payment must be paid by 14th September 2023. The remainder of the term 1 payment is due by 9th October 2023.

## LICENCE DATES

**Undergraduates - 22nd September 2023 - 26th July 2024**

**Postgraduates - 22nd September 2023 - 13th September 2024**

**Semester 1 - 22nd September 2023 - 26th January 2024**

**Semester 2 - 28th January 2023 - 14th June 2024**

# YOUR ROOM

## STANDARD BEDROOM/ LARGE STANDARD BEDROOM

### Items in the bedroom

Bed  
Curtains  
Wardrobe  
Desk & Chair  
Wi-Fi & Data Point  
Mirror

### Items in the communal space

Toaster  
Fridge  
Freezer  
Iron & Board  
Hob  
Microwave

**\*Corridor,  
kitchen and  
bathroom  
cleaned once  
a week**

Standard Bedroom - Single bed (Approx. 90 x 190)

Large Standard Bedroom - Small double bed (Approx. 120 x 190 cm)

[Take a tour of our Standard Bedroom](#)

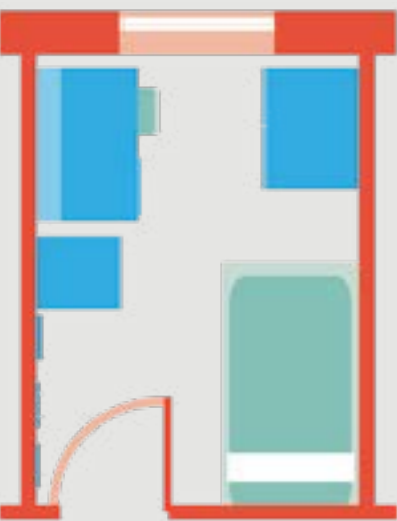

Please note room layouts may

# YOUR ROOM

## ENSUITE STUDIO/ LARGE ENSUITE STUDIO

Bed  
Curtains  
Wardrobe  
Desk & Chair  
Wi-Fi & Data Point  
Mirror  
Kettle

Fridge with chiller compartment  
Hob  
Microwave combination oven  
Dedicated ironing room (within the block)  
Wi-Fi & Data Point  
Mirror  
Kettle

**\*Corridor  
cleaned once  
a week**

Ensuite Studio - Single bed (Approx. 90 x 190)

Large Ensuite Studio -  
Small double bed (Approx. 120 x 190 cm)

[Take a tour of our Ensuite Studio Flat](#)



Please note room layouts may

## ENSUITE BEDROOM/ LARGE ENSUITE BEDROOM

### Items in the bedroom

Bed  
Curtains  
Wardrobe  
Desk & Chair  
Wi-Fi & Data Point  
Mirror

### Items in the communal space

Toaster  
Fridge  
Freezer  
Iron & Board  
Hob  
Microwave

**\*Corridor  
and kitchen  
cleaned once  
a week**

Ensuite Bedroom - Single bed (Approx. 90 x 190 cm)

Large Ensuite Bedroom - Small double bed (Approx. 120 x 190 cm)

[Take a tour of our Ensuite](#)

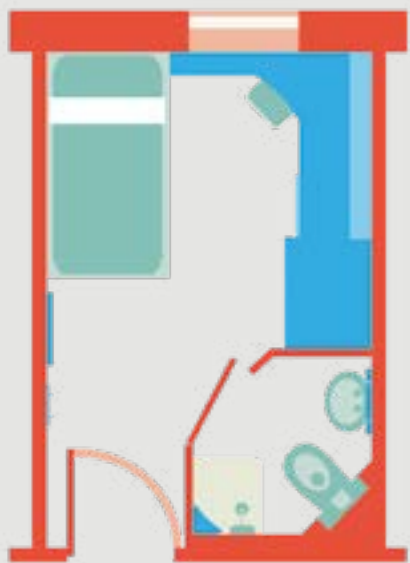

Please note room layouts may

## TWIN ENSUITE STUDIO/ LARGE TWIN ENSUITE STUDIO

Bed  
Curtains  
Wardrobe  
Desk & Chair  
Wi-Fi & Data Point  
Mirror  
Kettle

Fridge with chiller compartment  
Hob  
Microwave combination oven  
Dedicated ironing room (within the block)

**\*Corridor  
cleaned once  
a week**

Twin Ensuite Studio -  
2x Single bed (Approx. 90 x 190cm)

Large Twin Ensuite Studio -  
2x Single bed (90 x 190cm)

[Take a tour of our Twin Ensuite Studio Flat](#)

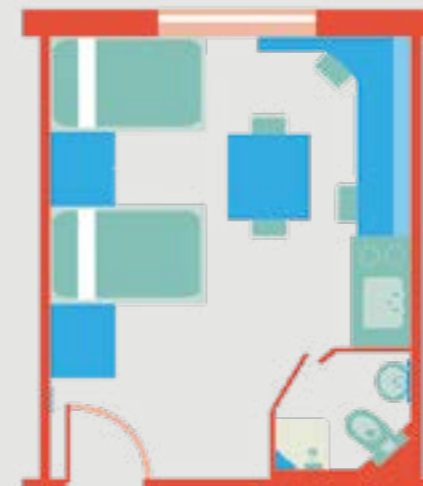

Please note room layouts may

# WHAT TO BRING

## BEDDING AND TOWELS

Bed linen (fitted base sheet, duvet, pillows and covers)  
Hand Towel/Bath towel  
Mattress Protector

## COOKING EQUIPMENT

Crockery (plate, bowl, mug and a glass)  
Sauce pan/frying pan  
Baking tray  
Tea towels  
Cutlery and cooking utensils

## OTHER ESSENTIALS

Clothes hangers (these are not provided)  
Warm coat, hat, gloves and a scarf  
Umbrella

## BEDDING PACKS

Bedding packs can be purchased at Reception upon arrival.

The pack consists of a hand towel, bath towel, fitted base sheet, duvet, pillow and covers.

Single  
£25

Double  
£35

VIEW OUR  
[WHAT TO BRING VIDEO](#)



# PROHIBITED ITEMS

## ANIMALS

## FAIRY LIGHTS

Unless battery operated

## CANDLES/INCENSE/JOSS STICKS

Or any items with a naked/covered flame

## CHIP PANS & DEEP FAT FRYERS

These are a high risk fire hazard

## CONVECTOR/FAN/HALOGEN HEATERS

Oil filled heaters are authorised

## OVER DOOR HANGERS

Do not use on your room door due to health and safety

## MINI FRIDGES

Medical fridges are available, please contact [BroadgateEnquiries@upp-ltd.com](mailto:BroadgateEnquiries@upp-ltd.com) to arrange,

The above list is not exhaustive and provided as a guide only. If you have any concerns about an item please contact Reception.

Room visits are carried out twice a year by the Residence Team. If prohibited items are found during visits, this will be raised as a concern and a course of action will be agreed upon.

If you wish to bring a rice cooker please ensure this is kept **ONLY** in your communal kitchen (studio excluded).

# USING YOUR SPACE SAFELY

VIEW OUR  
VIDEO ON  
[SAFE USE OF  
UK POWER  
OUTLETS](#)



## PREVENTION MEASURES

For safety reasons, our detection devices are highly sensitive and can be triggered by smoke, excessive steam or even aerosols. Close bathroom doors when showering. Never leave cooking unattended and always ventilate the area with the cooker hood and open windows. Smoking, vaping, naked or covered flames and deep fat frying are not permitted.

## GENERAL SAFETY TIPS

- Always carry your keys and keep them safe. Never give your keys to anyone else.
- Be aware of strangers on the premises. If you're not sure who someone is, please feel free to alert the staff.
- Always lock your door when you're going out and keep it closed at all times even if you are just nipping to the kitchen/bathroom.
- If you see anything suspicious, report it to staff as soon as possible.
- If your room is at ground level or easily accessible from the ground, make sure your windows are shut before you go out. Windows will only tilt outwards and should not open fully.
- If any fire doors are faulty please report this to staff.

# FIRE SAFETY

## WHAT YOU NEED TO KNOW



## IDENTIFY YOUR FIRE ASSEMBLY POINT

(these are displayed in your flat)



## IF YOU DISCOVER A FIRE



Raise the alarm and inform reception or the fire brigade without delay.

- Always treat all alarms as serious if they sound for longer than 60 seconds
- Evacuate the building as quickly as possible
- Make sure your flat mates have heard the alarm
- Make your way quickly to the fire assembly point
- Do not re-enter the building until it has been declared safe to do so

## FIRE EQUIPMENT

Emergency equipment is in place for the safety of all residents. The tampering of emergency equipment, be it Fire Alarms or emergency exits (wedging open flat doors), is a serious offence which not only puts your flat mate's lives at risk and makes your insurance invalid but is also a criminal act. As such this will be subject to disciplinary action by the Warden, which may result in heavy fines and the risk of eviction from your accommodation. Please observe all procedures in respect of this.



**FIRE DOORS SHOULD REMAIN CLOSED AT ALL TIMES AND SHOULD NOT BE WEDGED OPEN, DOING SO WILL POSE A SERIOUS SECURITY AND FIRE RISK.**

**SHOULD YOU BECOME AWARE OF A FIRE OR A HAZARD THAT COULD DEVELOP INTO A FIRE, PLEASE CONTACT RECEPTION IMMEDIATELY.**



## FIRE ALARM TEST



Fire alarms will be tested on a weekly basis every Thursday. You will not have to evacuate the building unless the alarm continues to sound for more than 60 seconds. In this case follow the evacuation procedures to the assembly point.

## LAUNDRY



Our main laundry is located next to the Reception.

All of the laundry rooms operate on the circuit laundry plus app (red and blue logo).

The app connects to the machine via Bluetooth and will give you a timer for your wash/dry so you know when its finished. All laundries are £3.50 to wash and £1.50 to dry.

## BIKE STORAGE



We have multiple bike storage areas across site. Please come to the reception to register and get a tag for your bike.

You will then be given access via your block access card. Only students using the bike sheds have access.

Bike storage is free to all students.

## POST AND PARCELS



Each flat has a shared mailbox which Royal Mail can access for delivery of letters and small parcels. Always include a contact number for packages so delivery drivers can contact you.

For delivery to our Reception Amazon locker, add 'Vine' to your address book. If the UniDrop multi courier parcel locker has been used for your deliveries you will be notified by text.

## PARKING



Parking permits are available for £300 per year.

Click [here](#) to download an application. Fixed penalty notices of £75 will be applied to non-permit holders or failing to display a permit.

(Parking regulations do not apply during intake) ALL visitors must report to the Reception.

# THE LOCAL AREA

## ALBION HOUSE AND BROADGATE PARK

Albion House and Broadgate Park are both located in the lively Nottingham suburb of Beeston. As well as using excellent local facilities you may want to head into the city or find the quickest route to campus. The following links provide a short insight into your local area.

## ALBION HOUSE

## BROADGATE PARK

### SUPERMARKETS

#### Tesco Extra (Beeston) NG9 2WJ

Mon – Sat 6am - 12am

Sun 11am - 5pm

0.4 miles from Albion  
0.8 miles from Broadgate

#### Sainsbury's (Beeston) NG9 2LA

Mon – Fri 8am - 10pm

Sat 7am - 10pm

Sun 10am - 4pm

0.1 miles from Albion  
0.4 miles from Broadgate

#### Lidl (Beeston) NG9 2NG

Mon – Sat 8am - 10pm

Sun 10am - 4pm

0.2 miles from Albion  
0.9 miles from Broadgate

#### Co-op (Beeston) NG9 2GJ

Mon – Sun 7am - 10pm

0.7 miles from Albion  
0.2 miles from Broadgate

### TRANSPORT

**DG Cars**  
0115 9500 500  
[dgcars.co.uk](http://dgcars.co.uk)



Albion House and Broadgate Park are in close proximity to a number of major bus routes heading into the city and Beeston. The tram is also easily accessible.

**UoN Hopper Buses**  
[UoN Hopper Bus Information](#)

**Trent Barton's Indigo service**  
[trentbarton.co.uk/services/indigo](http://trentbarton.co.uk/services/indigo)

**Nottingham City Transport's 36 service**  
[goo.gl/GP0zJe](http://goo.gl/GP0zJe)

**Nottingham Express Transit's Tram service**  
[thetram.net/](http://thetram.net/)

# THE LOCAL AREA

## CLOISTER HOUSE

# USEFUL INFORMATION

Welcome to Dunkirk, home to Queens Medical Centre, Showcase Cinema and a great student pub, The Johnson Arms. Cloister House is in the heart of this community favoured for pubs, takeaways and the

## CLOISTER HOUSE

### SUPERMARKETS

**Tesco Express (Castle Boulevard)**  
NG7 1SA  
Mon – Sun 7am - 11pm  
0.6 miles from Cloister House

**Sainsbury's (Castle Marina)**  
NG7 1GX  
Mon - Fri 7am - 11pm  
Sat - 7am - 10pm  
Sun 10am - 4pm  
1 mile from Cloister House

**SPAR**  
NG7 2RD  
Mon -Fri 9am - 4pm  
0.8 mile from Cloiser House

### TRANSPORT

**DG Cars**  
0115 9500 500  
[dgcars.co.uk](http://dgcars.co.uk)



Cloister House is in close proximity to both the major bus routes and tram line.

**UoN Hopper Buses**  
[UoN Hopper Bus Information](#)

**Trent Barton's Skylink service**  
[trentbarton.co.uk/services/skylinknottingham](http://trentbarton.co.uk/services/skylinknottingham)

**Nottingham City Transport's 34 service**  
[goo.gl/6cajX9](http://goo.gl/6cajX9)

**Nottingham Express Transit's Tram service**  
[thetram.net/](http://thetram.net/)

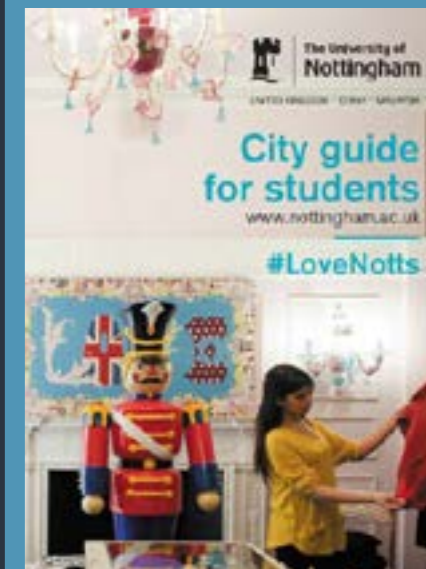
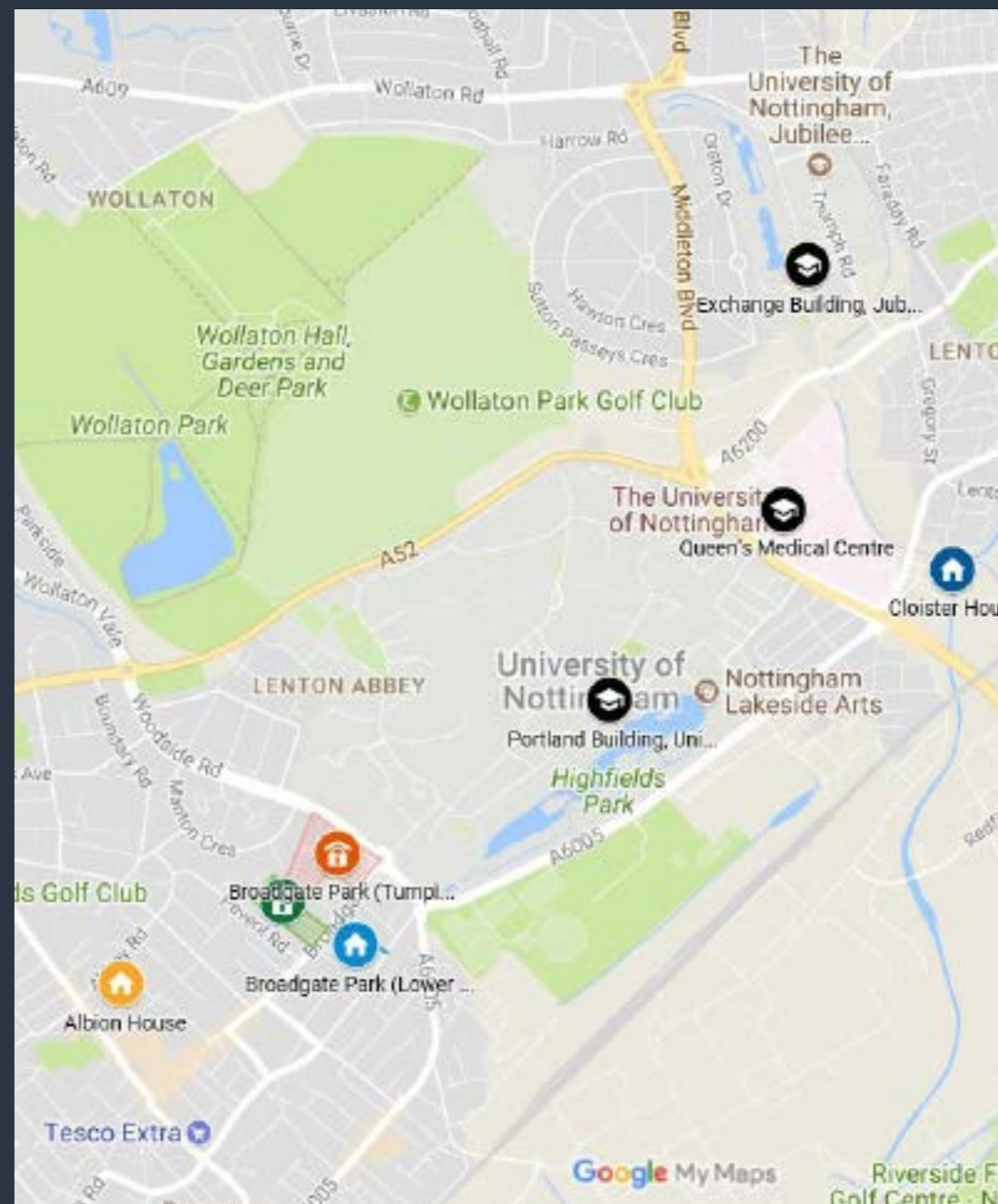

### HOTEL & B&B'S



**VIEW SHORT  
TERM  
ACCOMMODATION  
IN NOTTINGHAM**

# OUR MESSAGE TO YOU

A warm welcome to you all from the Broadgate park team  
It's now time to look forward to a year that makes wonderful memories.  
We hope you enjoy your stay with us and what Nottingham has to offer.



**Submit  
your room  
inventory**

**What's  
happening  
at your halls**

**Download our app**



**home at halls**

**Log a  
maintenance  
issue**

**Give  
feedback**

**Follow Us - Search broadgatepark**

